

A vertical bar on the left side of the slide, composed of several parallel lines in yellow, purple, green, and blue.

Chavis Park

COMMUNITY CONVERSATION

**Honoring our past.
Planning for our future.**

PLG Meeting #3 Understanding the Present

February 12, 2013



What is a Master Plan?

- A long range plan for development and use for an individual park site that includes a Program Statement guided by a **statement of vision**, a **description of elements** and depicted by a **conceptual graphic**.



Components of a Master Plan

- Program or Vision Statement
- Park and Program Elements
- Prioritization of Park and Program Elements
- Graphic Concept Plan



Vision Statement

- Definition: Describes the overall vision for the park, including uses, sensitivity to natural elements, identity, history, and other characteristics as appropriate
- The framework for your overall project
- Answers the Question: Where do we want to go?
- Your inspiration: An articulation of your dreams and hopes for the park.
- It reminds you of what you are trying to build



Park and Program Elements

- A list of elements/amenities with descriptions to include in the Master Plan
- The PLG will prioritize the elements for phased development of the park.

Graphic Concept Plan

- A visual representation showing where the elements/amenities should be located



Examples

- **1994 Chavis Park Master Plan**
- **2009 Strickland Road Master Plan**
- **2009 Isabella Cannon Park Master Plan**

Vision Statement

1994 Chavis Park Master Plan

The [1994] Master Plan Committee recognizes that because of its special history, Chavis Park enjoys a unique and valuable position within the Raleigh Parks System.

The Master Plan should reflect the history, heritage and tradition of the Chavis Park Community. The Park should foster ownership, care and pride by its users through the quality of its program, the quality and safety of its atmosphere, and its high level of maintenance.

Chavis Park should offer a variety of activities with a goal being to provide opportunities for interaction between users of all ages from surrounding communities.

Program Elements: Chavis Park

- A possible cultural arts center
- Upgrade, maintain the greenway to deter improper use
- Provide a strong pedestrian connection to Shaw University
- Renovate, expand and relocate the entrance of the Community Center to face the park and MLK Jr. Blvd
- Upgrade the ballfield to become a 'special' little league facility
- Relocate the carousel adjacent to the pool and boathouse to create a central 'Park Core Area'
- Create a performance or theater area adjacent to the old stone wall and stairs
- Upgrade and enhance the entrance image areas with walls, signage and plantings
- Provide outdoor basketball courts which can be supervised and monitored
- Provide a centralized concessions to work out of the bath house/core area
- Expand the idea of the Park Core Area to include the concept of the Children's Plaza and Enrichment/Community Center
- Encase Little Rock Creek along the Greenway, into a piping system or at least clean-up and stabilize its sides to reduce crime, hazards and infestation of insects.

Concept Plan: Chavis Park

1994 MP





Vision Statement

2009 Strickland Road Park Master Plan

A beautiful, people friendly, pet friendly place to enjoy nature and to play, exercise and gather in a woodland setting.



Program Elements: Strickland Rd.

- Trails – paved and unpaved
- Preservation of natural areas within the park,
- Picnic Area/ Picnic Shelters/Gathering Areas
- Children's Play Area/Outdoor Exercise Area/Nature Play
- Playfields – informal play lawns and open space field designated for youth play
- Pond Access
- Neighborhood Center
- Multi-use court
- Sustainable/Green Design
- Restrooms and parking for park users
- Outdoor classroom/informal performance space in bowl above pond

Concept Plan: Strickland Rd.

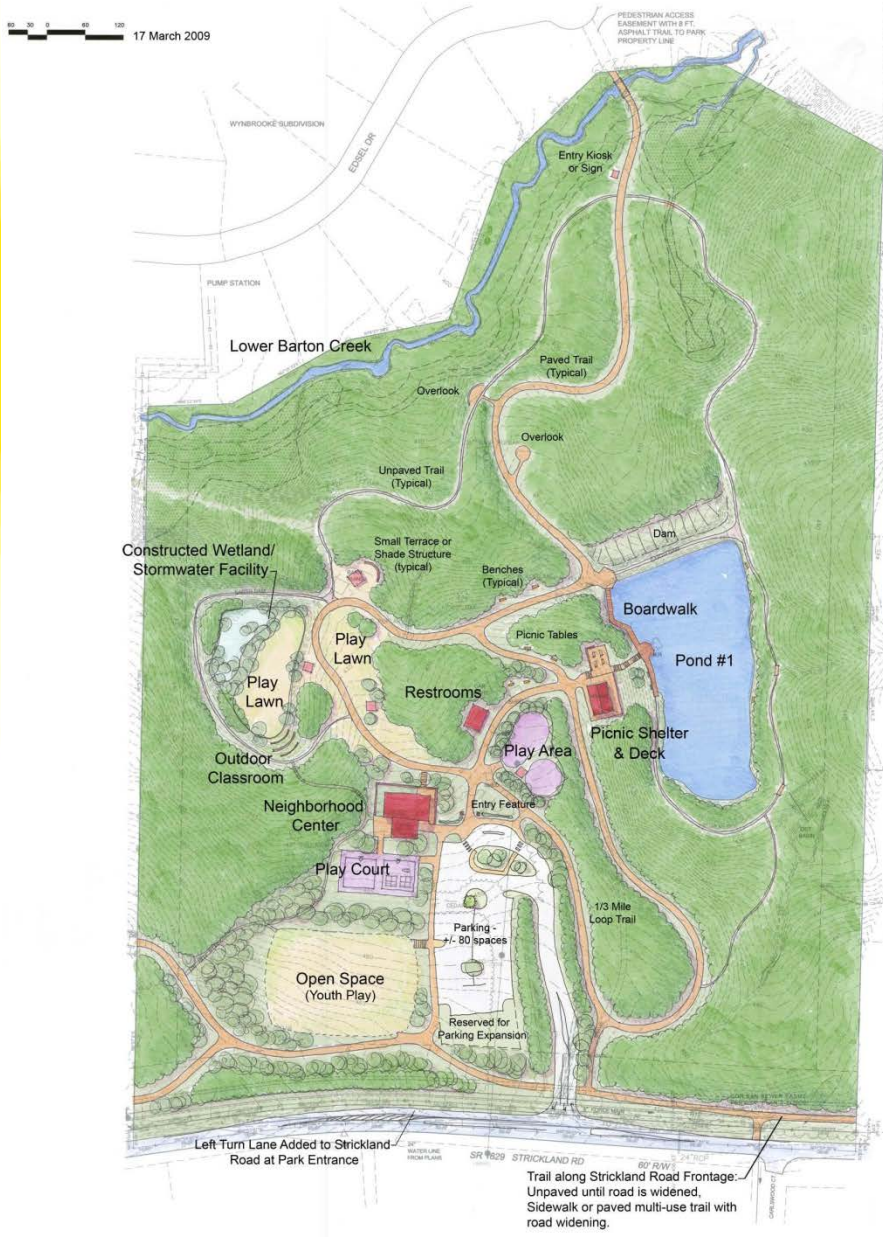



Vision Statement

2009 Isabella Cannon Park Master Plan

Isabella Cannon Park shall embrace its ability to become a place of social being - where neighbors meet and new friendships are made; where the young, and young at heart, play and exercise; and where the neighborhood becomes one with its community and memories are made. Isabella Cannon Park will emerge as the centerpiece of the neighborhood - a walkable, safe, friendly space that will provide a green respite for all those who pass by on their journey elsewhere. The Park's connection to other green spaces and focal points will also be encouraged as we provide greater access to and through the Park, with a result of strengthening its position as a key link in Raleigh's park system and chain of public spaces. Isabella Cannon Park will continue to develop as a place of joyful expression and community for all its users.

Program Elements Isabella Cannon

- Play pods for children of differing ages and swings
- Rock climbing feature
- Stage area/pavilion
- Continued use of the basketball court. Add court games.
- Correct drainage problems
- Paths for differing users
- Rain garden for stormwater management
- Meadow with pergola
- Outdoor classroom area
- Continued use of the existing play field
- Opportunity for interpretive signage
- Opportunity for bird garden
- Improved access to the park

Concept Plan: Isabella Cannon



LEGEND

	STEPS / STAIRS
	WIDE PAVED PEDESTRIAN PATH
	PAVED PEDESTRIAN PATH
	SOFT PEDESTRIAN PATH (FIELD LOCATED)
	PROPERTY LINE
	CONTOUR
	TREELINE

NOTE: PLAN SHOWN IS FOR ILLUSTRATIVE PURPOSES ONLY.